

## 1 安装准备

配件盒内包含：

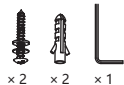

电钻



电钻头



铅笔

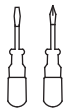

螺丝刀

## 2 铅笔定位并打孔

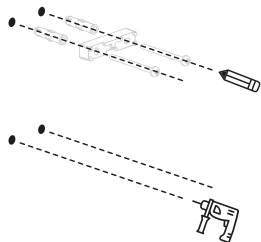

## 3 将膨胀胶塞装入墙孔内 将螺帽和螺丝对孔锁紧至膨胀胶塞内

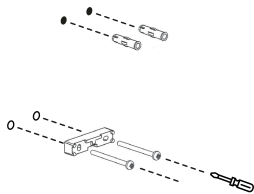

## 4 将产品套入底座并拧紧内六角螺丝 玻璃器皿插入托架，安装完毕

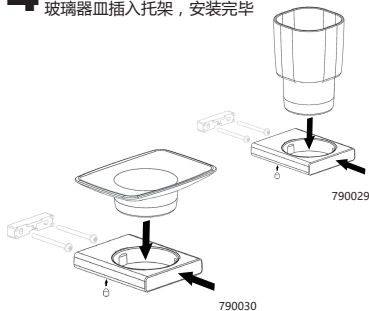

**ALISEO** GmbH  
G E R M A N Y

# 安装说明书

适用产品型号：790029/790030

ALISEO GmbH  
Leutkirchstrabe63·77723  
Gengenbach·Germany  
E-mail: Info@aliseo.de  
info@aliseochina.com

www.aliseo.de  
www.aliseochina.com

## 1 安装准备

配件盒内包含：

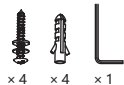

电钻



电钻头



铅笔

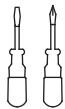

螺丝刀

## 2 铅笔定位并打孔

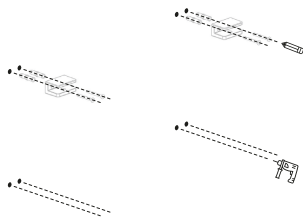

## 3 将膨胀胶塞装入墙孔内 将螺丝穿入底座后锁紧至膨胀胶塞内

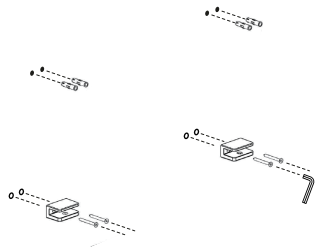

## 4 将玻璃层架插入底座，安装完毕

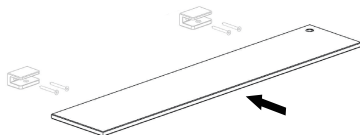

**ALISEO** GmbH  
G E R M A N Y

# 安装说明书

适用产品型号：790031

ALISEO GmbH  
Leutkirchstrabe63·77723  
Gengenbach·Germany  
E-mail: Info@aliseo.de  
info@aliseochina.com

www.aliseo.de  
www.aliseochina.com